

For Lease



100 LIGHTING WAY
SECAUCUS



CHILMARK
REAL ESTATE SERVICES, LLC

MICHAEL MARCHESE, *Executive Managing Director*
marchese@chilmarkre.com | 201-801-1400

EDWARD M. FLANAGAN, *Founding Member*
flanagan@chilmarkre.com | 201-801-1900

HIGHLIGHTS & FEATURES:



Premier Headquarters Building



Entire 2nd Floor: 32,000 RSF
Divisible to 16,000 RSF



Ample Parking 4/1000
Including Significant Covered



Term: Negotiable



Pricing: Upon Request



Full service cafeteria
including executive dining
area



24 hour security-key card
access



Back up generator



Floorplate divides naturally capturing great lobby exposure

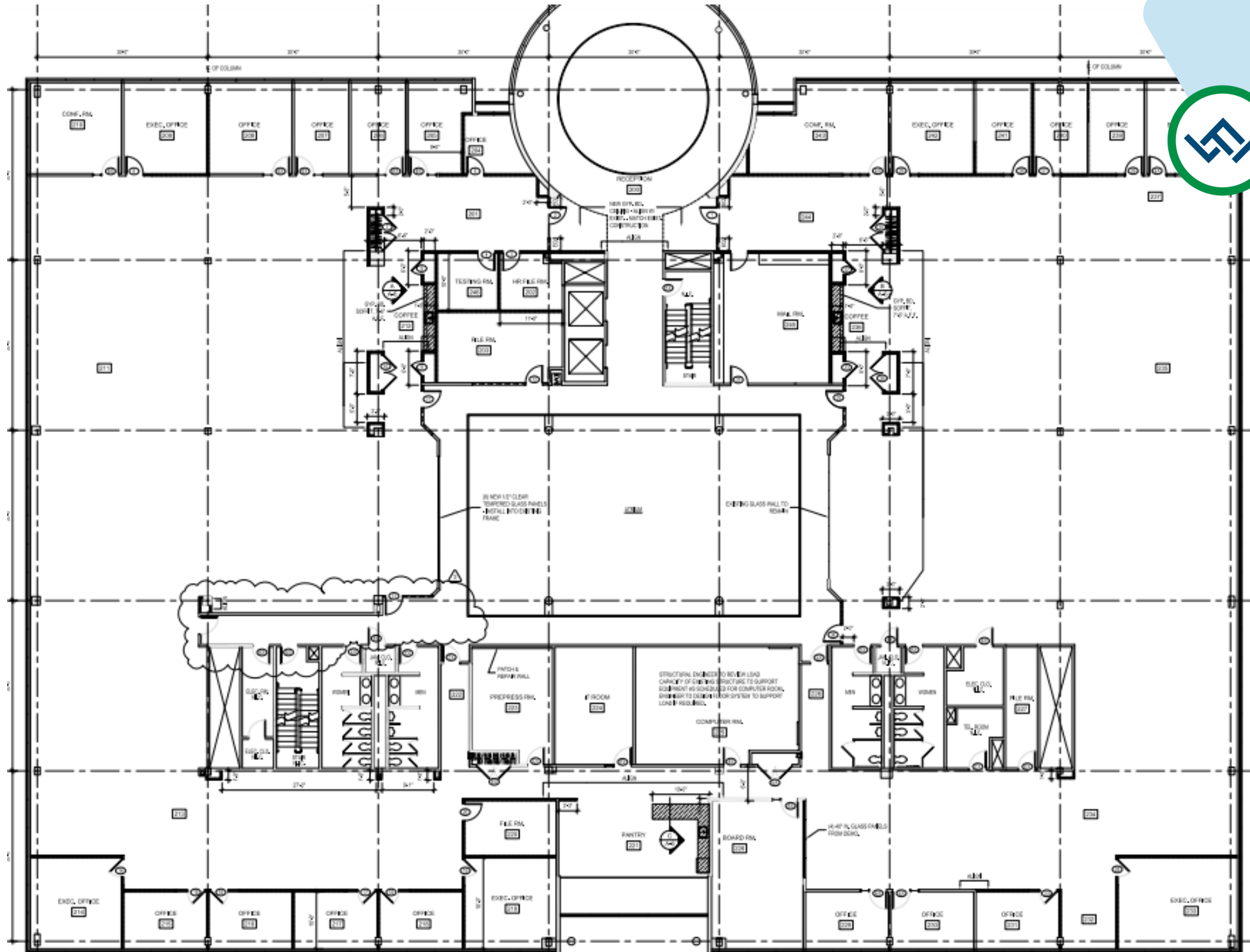

Very noticeable natural light entering throughout the entire building



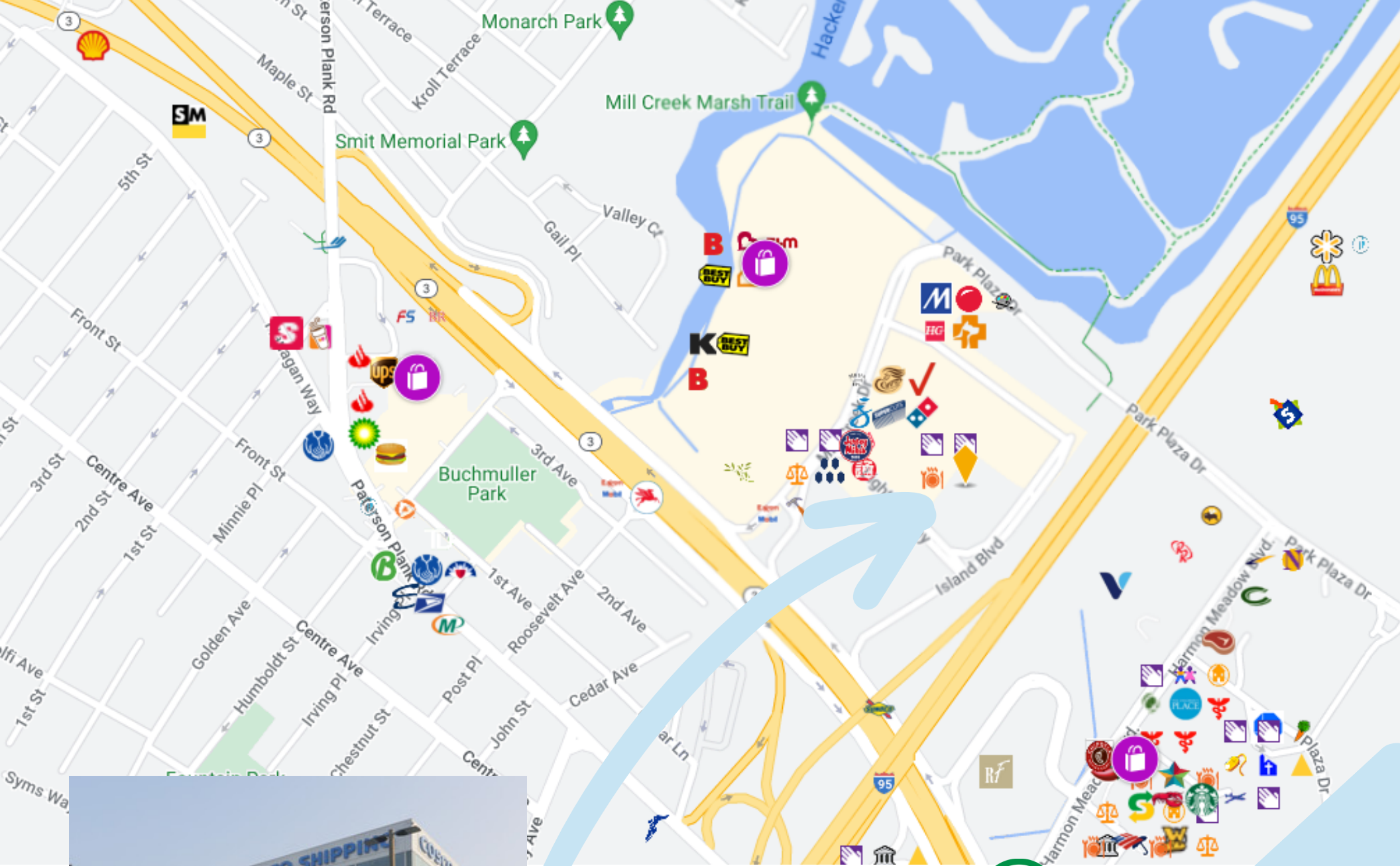

For Lease

100 LIGHTING WAY
SECAUCUS



CHILMARK
REAL ESTATE SERVICES, LLC

MICHAEL MARCHESE, Executive Managing Director
marchese@chilmarkre.com | 201-801-1400
EDWARD M. FLANAGAN, Founding Member
flanagan@chilmarkre.com | 201-801-1900